

# MD LOW RANGE COMPOUND SWITCHES

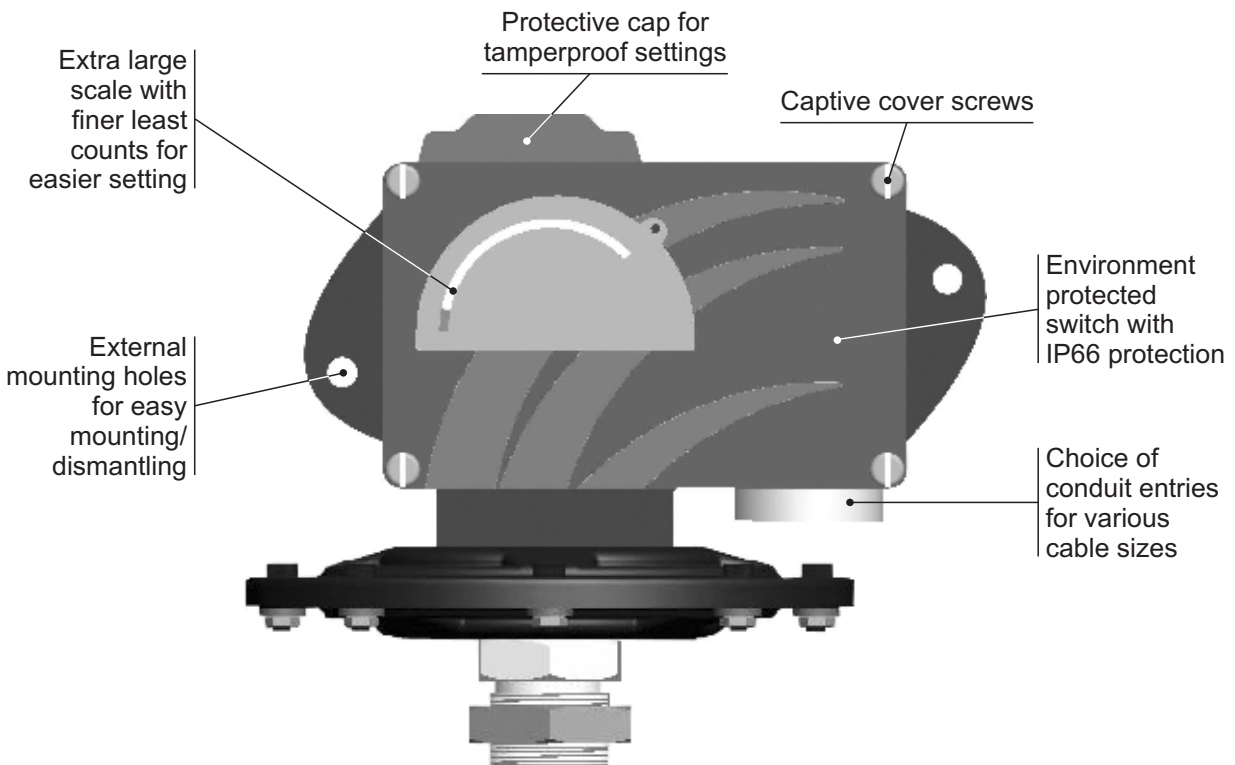
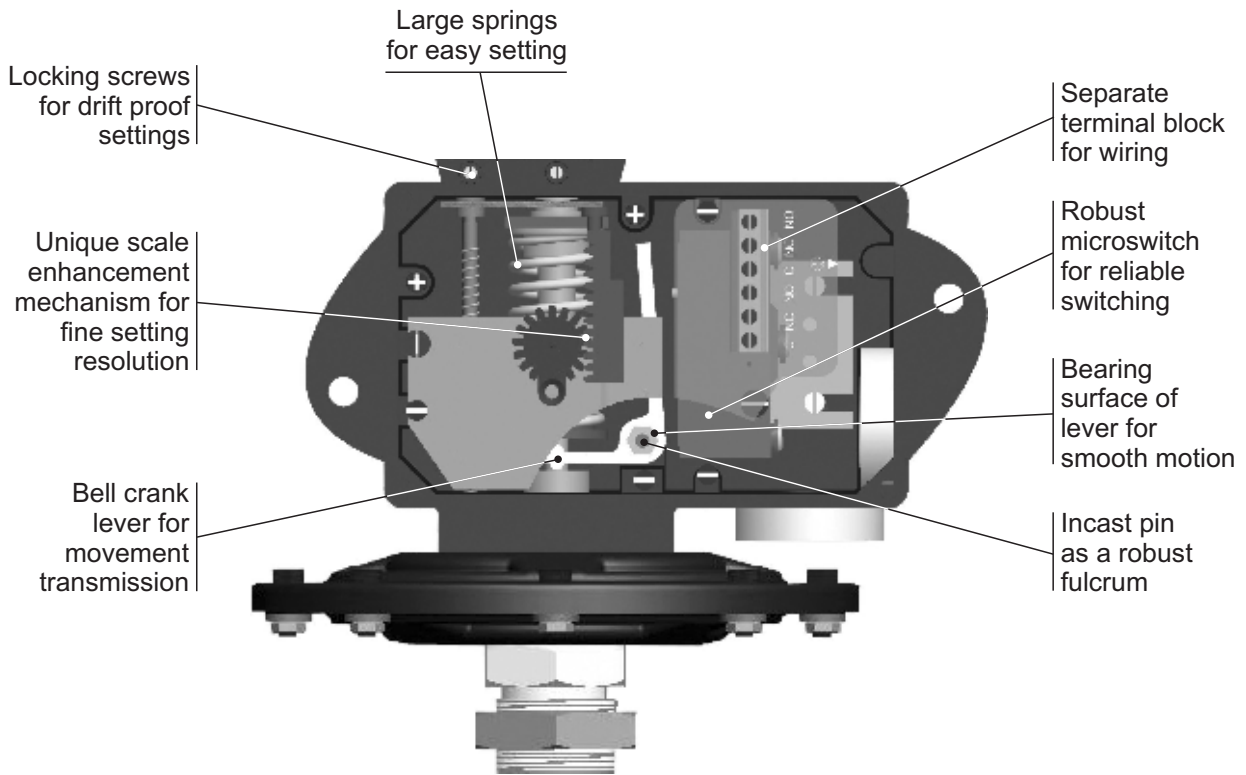

**Approximate Weight :** 1.500 Kg.

**Some Applications :** Used in furnaces, turbines etc.

**Electrical Connection :**

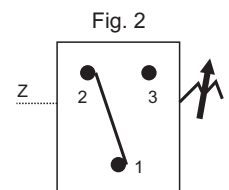

# LOW RANGE COMPOUND SWITCHES MD



## PRESSURE CAPSULE DETAILS

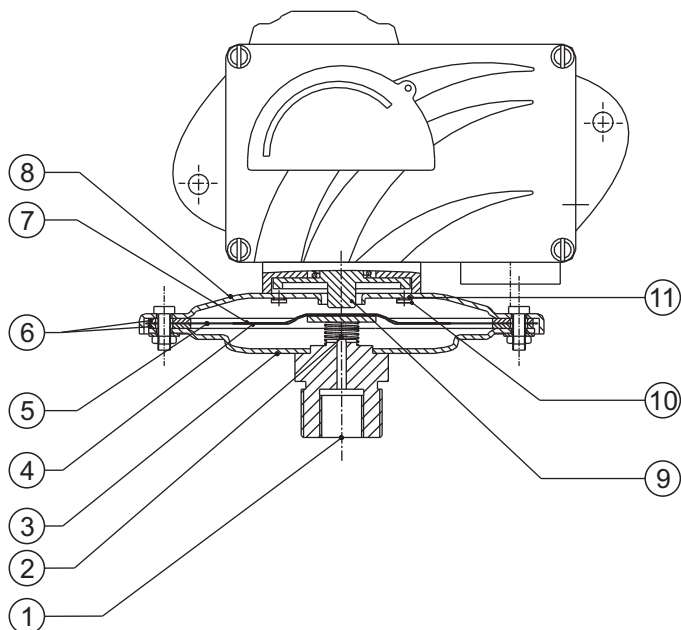

- No. Description**
1. *Pressure port (M.S.)\**
  2. *Support spring (S.S.)*
  3. *Bottom flange (M.S.)*
  4. *Support plate (Aluminium)*
  5. *Diaphragm (Neoprene)*
  6. *Gasket (Nitrile)*
  7. *Top plate (Aluminium)*
  8. *Top flange (M.S.)*
  9. *Plunger*
  10. *Top flange screw (M.S.)*
  11. *Sealing 'O' ring (Nitrile)*

\*Pressure port is brazed with flange

Note : *wetted parts* are mentioned in italics.

## INSTALLATION DRAWING

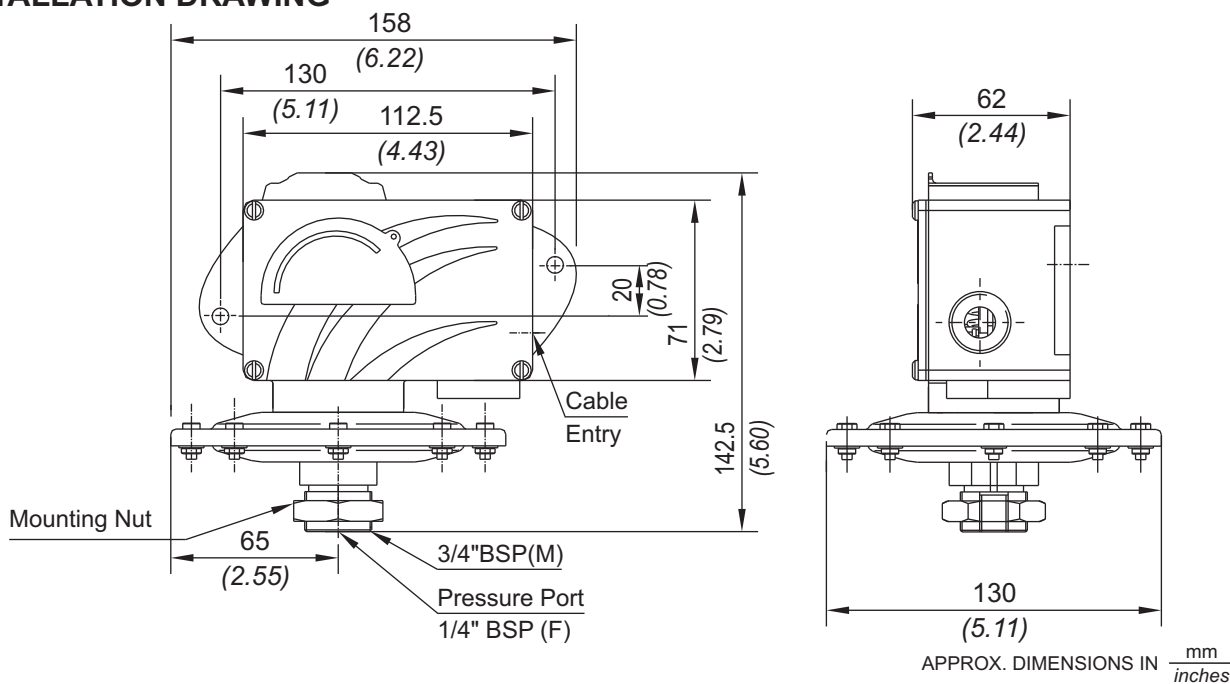

# MD LOW RANGE COMPOUND SWITCHES

## RANGE SELECTION TABLE

Range Code	Range mm wc ("wc)	Differential* mm wc ("wc)	Maximum Working Pressure bar (psi)
		Approximate Maximum for "A1" microswitch	
CL2	-150 to 150 (-5.905 to 5.905)	40 (1.605)	2 (29.00)
CL3	-250 to 250 (-9.842 to 9.842)	60 (2.410)	2 (29.00)

\*Minimum differential increases with setpoint, values with neoprene diaphragm (Graphs available on request)

\* Differentials of microswitches A2 through A9 will vary. Differentials for A7 are typically twice that for A1 microswitch. Please indicate specifically the differential value in enquiry/order, when it is critical in your application.

## HOW TO ORDER INDUSTRIAL LOW RANGE COMPOUND SWITCHES

Group 1	Group 2	Group 3	Group 4	Group 5	Group 6	Group 7	Group 8
Non standard allocation	Gas Group Classification	Cable Entry Size	Switch Type	Range Code (values in mm wc)	Microswitch Type	Pressure Port Material / Size	Diaphragm
<input type="checkbox"/> Reserved for non-standard options not covered in catalogue. Will be given by manufacturer, only after agreement of supply details with customer.	<b>MD</b> = Industrial pressure switch with diecast Aluminium enclosure to IP66 as per IS2147	<b>1</b> = 1/2" NPT threads <b>2</b> = 3/4" NPT threads <b>3</b> = M20 X 1.5 threads	<b>CF1</b> = Compound switch, fixed differential without scale	<b>CL2</b> = (-150 to 150) <b>CL3</b> = (-250 to 250)	<b>A1</b> = General purpose microswitch rated at 15A; 250 VAC <b>A2</b> = Hermetically sealed for corrosive environments <b>A3</b> = gold plated contacts for low voltage applications <b>A4</b> = DPDT configuration <b>A5</b> = for high DC ratings <b>A6</b> = elements with adjustable deadband <b>A7</b> = 2SPDT switching elements <b>A9</b> = General purpose microswitch rated at 5A; 250 VAC  * Some microswitches may not be available for particular ranges. Please check with sales office. Please refer page no. 230 for more microswitch options	<b>S1</b> = SS316 / 1/4" BSP(F) <b>S2</b> = SS316 / 1/4" NPT(F)  <b>0</b> = Neoprene <b>1</b> = Teflon  Please refer page no. 226 & 227 for more pressure port options	For additional wetted parts please refer Pressure Capsule Details on Page 167

eg. A flameproof switch for gas group IIC, with 1/2" NPT cable entry in aluminium housing as 1SPDT pressure switch, having -150 to 150 mm wc pressure range, with 15Amp. microswitch, SS316 pressure housing with 1/4" BSP port size & neoprene diaphragm shall be specified by

Group 1	Group 2	Group 3	Group 4	Group 5	Group 6	Group 7	Group 8
<input type="checkbox"/>	MD	1	CF1	CL2	A1	S1	0

Please specify full model number to avoid ambiguity. If only the first two groups are specified while ordering, uncalibrated switches with standard wetted parts and enclosures will be supplied.